

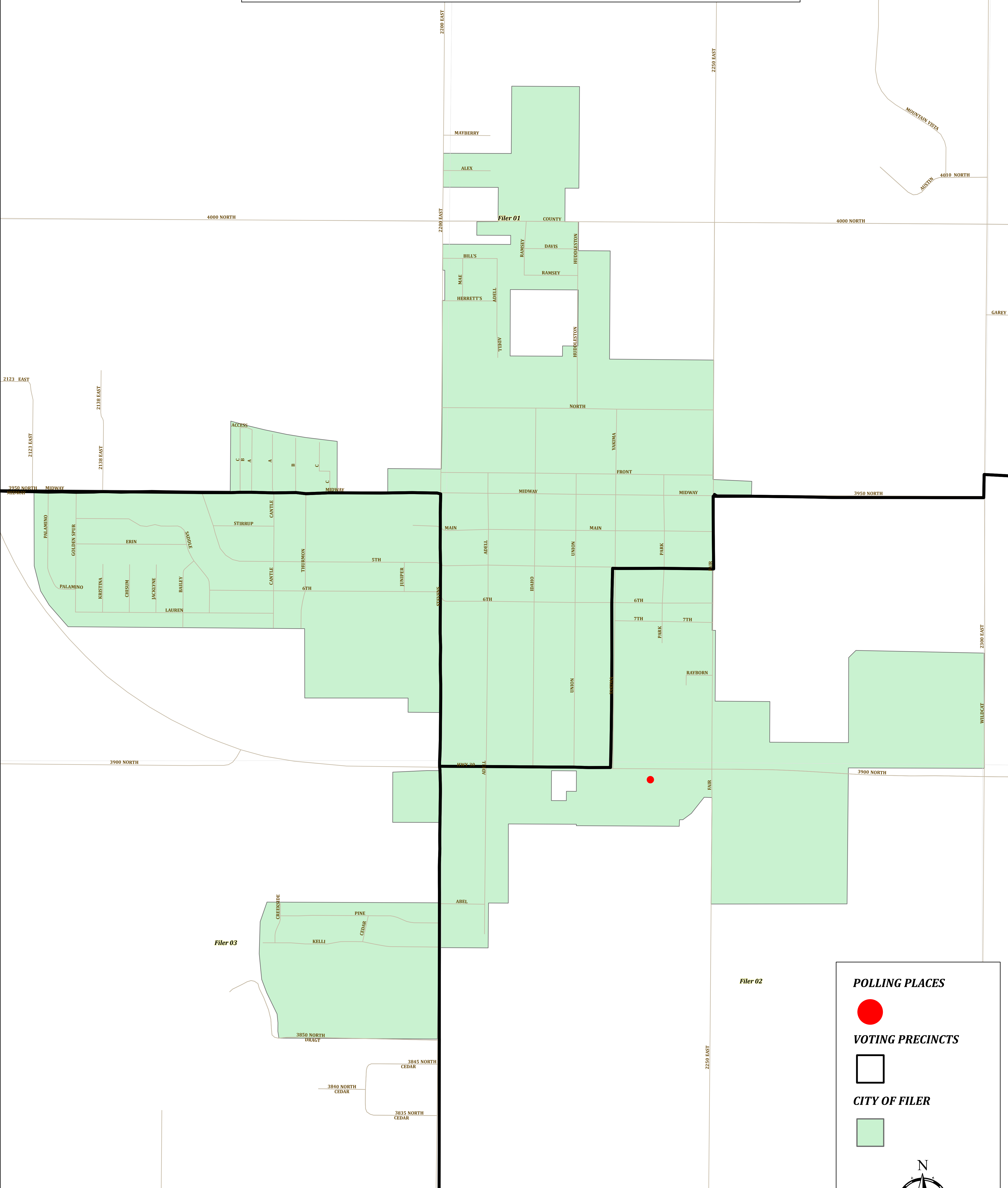

# TWIN FALLS COUNTY

## CITY OF FILER WITH VOTER PRECINCTS & POLLING LOCATIONS



BUHL #1	MOOSE HALL, 1101 MAIN ST	HOLLISTER	HOLLISTER ELEMENTARY SCHOOL, 2463 CONTACT AVE
BUHL #2	MOOSE HALL, 1101 MAIN ST	KIMBERLY #1	CROSSROADS UNITED METHODIST CHURCH, 131 SYRINGA AVE
BUHL #3	FIRST CHRISTIAN CHURCH, 1005 POPLAR ST	KIMBERLY #2	CHURCH OF JESUS CHRIST OF LATTER DAY SAINTS, 222 BIRCH ST S
BUHL #4	FIRST CHRISTIAN CHURCH, 1005 POPLAR ST	KIMBERLY #3	CROSSROADS UNITED METHODIST CHURCH, 131 SYRINGA AVE
BUHL #5	FIRST CHRISTIAN CHURCH, 1005 POPLAR ST	KIMBERLY #4	CHURCH OF JESUS CHRIST OF LATTER DAY SAINTS, 222 BIRCH ST S
CASTLEFORD	CASTLEFORD COMMUNITY CENTER, 475 W MAIN	MAROA	FILER MIDDLE SCHOOL GYM, 299 HWY 30
DEEP CREEK	BUHL FIRE STATION #2, 19266-A HWY 30	MURTAUGH	MURTAUGH CITY HALL, 106 4TH ST
FILER #1	FILER MIDDLE SCHOOL GYM, 299 HWY 30	TWIN FALLS #24	AMAZING GRACE FELLOWSHIP, 1061 EASTLAND DR N
FILER #2	FILER MIDDLE SCHOOL GYM, 299 HWY 30	TWIN FALLS #25	CHURCH OF JESUS CHRIST OF LATTER-DAY SAINTS, 541 ORCHARD DR
FILER #3	FILER MIDDLE SCHOOL GYM, 299 HWY 30	TWIN FALLS #26	CHURCH OF JESUS CHRIST OF LATTER-DAY SAINTS, 541 ORCHARD DR
HANSEN	ASSEMBLY OF GOD CHURCH, 319 2 <sup>ND</sup> ST E	ABSENTEE POLLING	TWIN FALLS COUNTY WEST, 630 ADDISON AVE W

**POLLING PLACES**

VOTING PRECINCTS

CITY OF FILER

*THIS MAP IS FOR ELECTION PURPOSES ONLY. TWIN FALLS COUNTY IS NOT RESPONSIBLE FOR ANY INACCURACIES HEREIN CONTAINED.*

COPYRIGHT: TF COUNTY 2017